



# HANDYWAY

## 2014



**HANDYWAY CO., LTD**

**Taiwan**

No. 101-16, Sec. 1, Zhong Xing Rd., Hemei Town, Changhua 50854 Taiwan.

Tel: 886-4-7355866 Fax: 886-4-7355865

Email: [sales@handyway.com.tw](mailto:sales@handyway.com.tw)

[www.handywaylock.com.tw](http://www.handywaylock.com.tw)

**China**

Quzhong Road, Ludu Town, Taicang City, Jangsu China 215412

Tel: 86-512-82785667 Fax: 86-512-82785679

[www.handywaylock.com](http://www.handywaylock.com)



**The professional maker of  
the high security lock products**





## About the Company

Established in 1990, Handyway Company is built solidly on a foundation of successful lock and cable manufacturing operation. Handyway manufacturing is among the leading high performance brands in bicycle accessories and vehicle towing locks. The products are sold in more than 25 countries world wide.

### Highlights

Handyway Company is committed and continues the emphasis on product innovation and stronger security system. The company is one of the industry's premier manufactures, and with the best expertise in this field.

### Adding Value to Tomorrow

Handyway Company is determined to deliver outstanding results and performance in product innovation designed to enhance security, appearance, durability and superior quality. These strategies are necessary to lead Handyway forward to years of growth and prosperity.

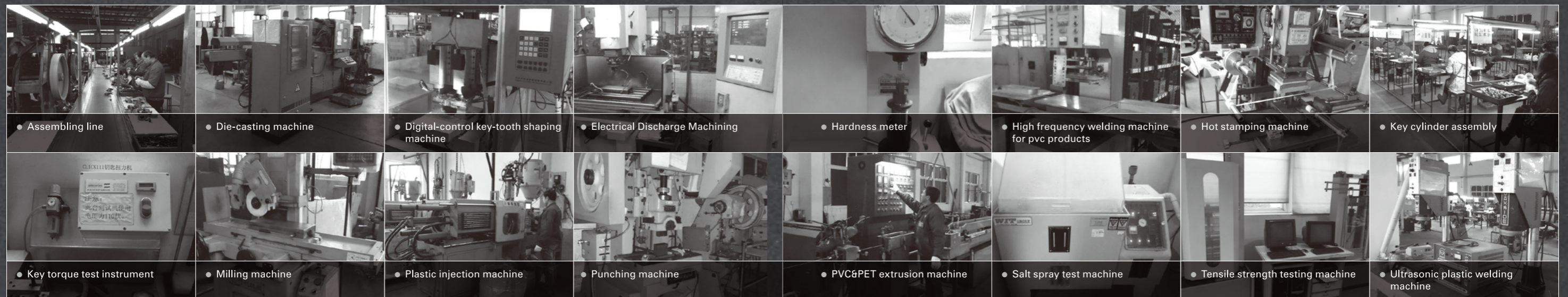



## Index

HANDYWAY CO., LTD

- 01 LED KEY COVER
- 02 CHILDREN LOCK
- 04 CABLE LOCK
  - \* Available in different colors and size Strong Cable
- 19 COMBINATION LOCK
- 28 U-LOCK
- 31 POCKET LOCK
- 34 RETRACTABLE LOCK
- 37 FOLDING LOCK
- 38 FRAME LOCK
- 40 RACK LOCK
- 42 DISK LOCK
- 44 MULTI-PURPOSE
- 47 PAD LOCK
- 50 HEAVY DUTY CHAIN / JOINT LOCK
- 54 CYLINDER
- 55 PRODUCT PACKAGE

# HANDYWAY



## LED KEY COVER

[www.handywaylock.com.tw](http://www.handywaylock.com.tw)

### KC-02

1. LED light key for ease of use after dark

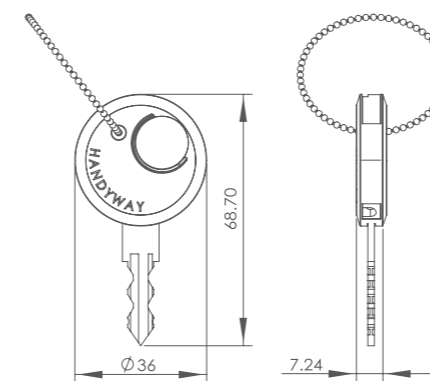

HANDYWAY





**CHILDREN LOCK**

[www.handywaylock.com.tw](http://www.handywaylock.com.tw)

**CHILDREN LOCK**

CL-452



1. Adorable shape with different colors available

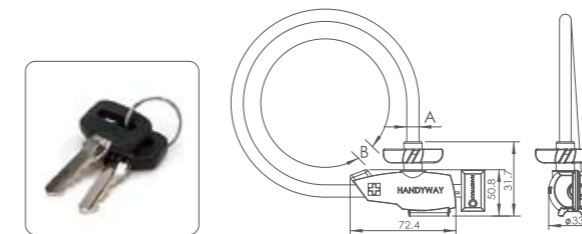

A	B
8mm x 60cm	
8mm x 90cm	
8mm x 120cm	
8mm x 150cm	
8mm x 180cm	



CL-862



1. Adorable shape with different colors available  
2. Preset combination lock

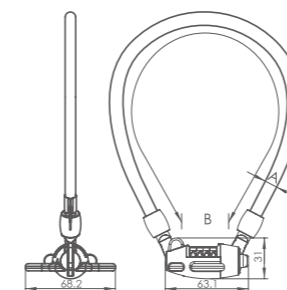

A	B	A	B
6mm x 60cm		8mm x 60cm	
6mm x 90cm		8mm x 90cm	
6mm x 120cm		8mm x 120cm	
6mm x 150cm		8mm x 150cm	
6mm x 180cm		8mm x 180cm	





HANDYWAY



**CABLE LOCK**

[www.handywaylock.com.tw](http://www.handywaylock.com.tw)

## CABLE LOCK

Available in different colors and size Strong Cable

CL-101



1. Heavy duty self coiling cable
2. Vinyl coating prevents scratches professional lock
3. Sliding dust cover protects keyway from natural elements



A	B
15mm x 60cm	
15mm x 90cm	
15mm x 120cm	
15mm x 150cm	
15mm x 180cm	

CL-608



1. Flexible TPE coatings on the locking mechanism
2. Flexible TPE cable cover with different colors available

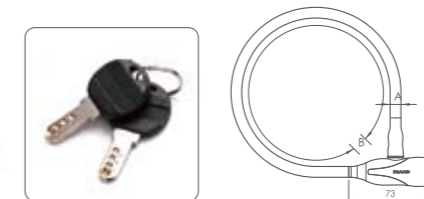

A	B	A	B	A	B
8mm x 60cm		10mm x 60cm		12mm x 60cm	
8mm x 90cm		10mm x 90cm		12mm x 90cm	
8mm x 120cm		10mm x 120cm		12mm x 120cm	
8mm x 150cm		10mm x 150cm		12mm x 150cm	
8mm x 180cm		10mm x 180cm		12mm x 180cm	



# CABLE LOCK

Available in different colors and size Strong Cable

## CL-445



1. Adjustable cable lock
2. Soft rubber cover
3. Diameter: 10mm (A), Length: 120/150/180/210cm (B)

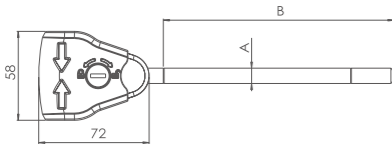

A	B
10mm x 120cm	
10mm x 150cm	
10mm x 180cm	
10mm x 210cm	

## CL-212 W/BL-722



1. Integrated Cable Lock
2. Carrying bracket including
3. Reliable steel cable locks provide expedient protection
4. Vinyl coating protects bike
5. Professional key lock

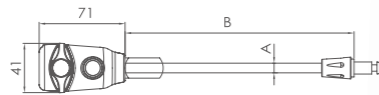

A	B	A	B	A	B
8mm x 60cm		10mm x 60cm		12mm x 60cm	
8mm x 90cm		10mm x 90cm		12mm x 90cm	
8mm x 120cm		10mm x 120cm		12mm x 120cm	
8mm x 150cm		10mm x 150cm		12mm x 150cm	
8mm x 180cm		10mm x 180cm		12mm x 180cm	

## CL-404 W/BL-404



1. Integrated Cable Lock
2. Carrying bracket including
3. Patent design
4. Reliable steel cable locks provide expedient protection
5. Vinyl coating protects bike
6. Professional key lock

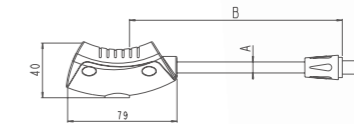

A	B	A	B	A	B
8mm x 60cm		10mm x 60cm		12mm x 60cm	
8mm x 90cm		10mm x 90cm		12mm x 90cm	
8mm x 120cm		10mm x 120cm		12mm x 120cm	
8mm x 150cm		10mm x 150cm		12mm x 150cm	
8mm x 180cm		10mm x 180cm		12mm x 180cm	

## CL-407 W/BL-407



1. Sliding Dust cover protects keyway from natural elements
2. Carry bracket including
3. Patent design
4. Reliable steel cable locks provide expedient protection
5. Vinyl coating protects bike
6. Professional key Lock

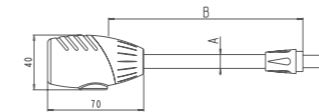

A	B	A	B	A	B
8mm x 60cm		10mm x 60cm		12mm x 60cm	
8mm x 90cm		10mm x 90cm		12mm x 90cm	
8mm x 120cm		10mm x 120cm		12mm x 120cm	
8mm x 150cm		10mm x 150cm		12mm x 150cm	
8mm x 180cm		10mm x 180cm		12mm x 180cm	



# CABLE LOCK

Available in different colors and size Strong Cable

## CL-408 W/BL-408



1. Carry bracket including
2. Patent design
3. Reliable steel cable locks provide expedient protection
4. Vinyl coating protects bike
5. Professional key Lock

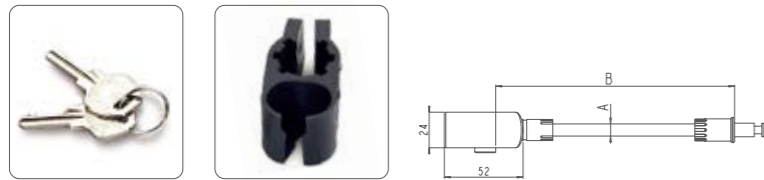

A	B	A	B
8mm x 60cm	10mm x 60cm		
8mm x 90cm	10mm x 90cm		
8mm x 120cm	10mm x 120cm		
8mm x 150cm	10mm x 150cm		
8mm x 180cm	10mm x 180cm		

## CL-200 W/BL-718



1. High Security Cable Lock
2. Lock pin spring out upon opening
3. Variety color assortment is available
4. Vinyl coating and scratch guard
5. Patented bracket is extremely convenient



A	B	A	B	A	B
8mm x 60cm	10mm x 60cm			12mm x 60cm	
8mm x 90cm	10mm x 90cm			12mm x 90cm	
8mm x 120cm	10mm x 120cm			12mm x 120cm	
8mm x 150cm	10mm x 150cm			12mm x 150cm	
8mm x 180cm	10mm x 180cm			12mm x 180cm	

## CL-2000 W/BL-718



1. High Security Cable Lock
2. Lock pin spring out upon opening
3. Variety color assortment is available
4. Vinyl coating and scratch guard
5. Patented bracket is extremely convenient

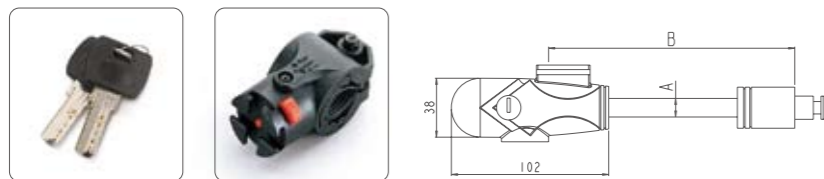

A	B	A	B	A	B
12mm x 60cm	15mm x 60cm			20mm x 60cm	
12mm x 90cm	15mm x 90cm			20mm x 90cm	
12mm x 120cm	15mm x 120cm			20mm x 120cm	
12mm x 150cm	15mm x 150cm			20mm x 150cm	
12mm x 180cm	15mm x 180cm			20mm x 180cm	

## CL-220 W/BL-718



1. V-shaped Integrated Cable Lock
2. Lock pin spring out upon opening
3. Variety color assortment is available
4. Vinyl coating and scratch guard
5. Patented bracket is extremely convenient



A	B	A	B	A	B
10mm x 60cm	12mm x 60cm			15mm x 60cm	
10mm x 90cm	12mm x 90cm			15mm x 90cm	
10mm x 120cm	12mm x 120cm			15mm x 120cm	
10mm x 150cm	12mm x 150cm			15mm x 150cm	
10mm x 180cm	12mm x 180cm			15mm x 180cm	



# CABLE LOCK

Available in different colors and size Strong Cable

## CL-927 W/BL-715 or W/BL-718



1. Integrated Cable Lock
2. Reliable steel cable locks provide expedient protection
3. Vinyl coating protects bike
4. Lock pin spring out upon opening
5. Carrying bracket including

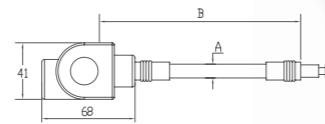

A	B	A	B	A	B
8mm	60cm	10mm	60cm	12mm	60cm
8mm	90cm	10mm	90cm	12mm	90cm
8mm	120cm	10mm	120cm	12mm	120cm
8mm	150cm	10mm	150cm	12mm	150cm
8mm	180cm	10mm	180cm	12mm	180cm

## CL-951 W/BL-718



1. Integrated Cable Lock
2. Carrying bracket including
3. Patent design
4. Reliable steel cable locks provide expedient protection
5. Vinyl coating protects bike
6. Lock pin spring out upon opening

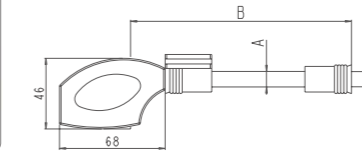

A	B	A	B	A	B	A	B
8mm	60cm	10mm	60cm	12mm	60cm	15mm	60cm
8mm	90cm	10mm	90cm	12mm	90cm	15mm	90cm
8mm	120cm	10mm	120cm	12mm	120cm	15mm	120cm
8mm	150cm	10mm	150cm	12mm	150cm	15mm	150cm
8mm	180cm	10mm	180cm	12mm	180cm	15mm	180cm

## CL-928



1. Integrated Cable Lock
2. Reliable steel cable locks provide expedient protection
3. Vinyl coating protects bike
4. Lock pin spring out upon opening

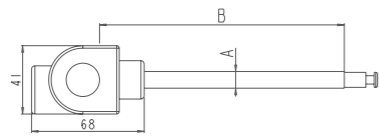
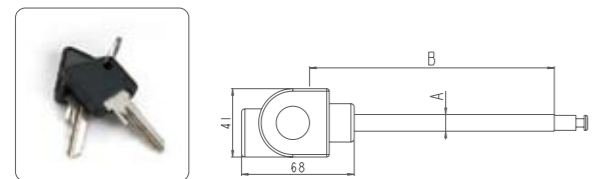

A	B
14mm	60cm
8mm steel wire, 14mm PVC tube	

## CL-952



1. Integrated Cable Lock
2. Reliable steel cable locks provide expedient protection
3. Vinyl coating protects bike
4. Lock pin spring out upon opening

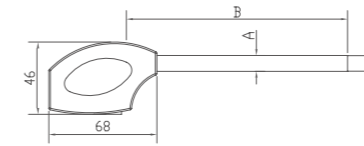
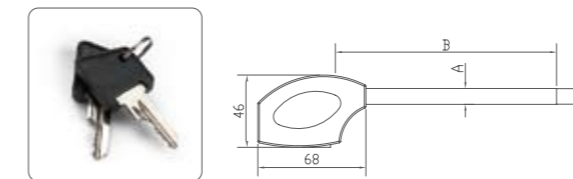

A	B
14mm	60cm
8mm steel wire, 14mm PVC tube	



# CABLE LOCK

Available in different colors and size Strong Cable

## CL-911 W/BL-712 or W/BL-718



1. Integrated Cable Lock
2. Reliable steel cable locks provide expedient protection
3. Vinyl coating protects bike
4. Lock pin spring out upon opening
5. Carrying bracket including



A	B	A	B	A	B
8mm x 60cm	10mm x 60cm	10mm x 60cm	12mm x 60cm	12mm x 60cm	
8mm x 90cm	10mm x 90cm	10mm x 90cm	12mm x 90cm	12mm x 90cm	
8mm x 120cm	10mm x 120cm	10mm x 120cm	12mm x 120cm	12mm x 120cm	
8mm x 150cm	10mm x 150cm	10mm x 150cm	12mm x 150cm	12mm x 150cm	
8mm x 180cm	10mm x 180cm	10mm x 180cm	12mm x 180cm	12mm x 180cm	

## CL-912



1. Integrated Cable Lock
2. Reliable steel cable locks provide expedient protection
3. Vinyl coating protects bike
4. Lock pin spring out upon opening

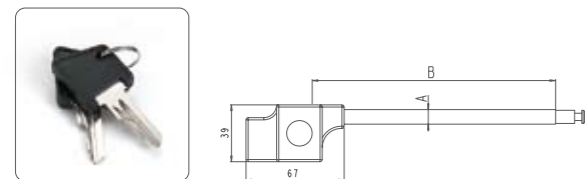

A	B
14mm x 60cm	
8mm steel wire, 14mm PVC tube	

## CL-923 W/BL-721



1. Integrated Cable Lock
2. Reliable steel cable locks provide expedient protection
3. Vinyl coating protects bike
4. Lock pin spring out upon opening
5. Carrying bracket including



A	B	A	B
8mm x 60cm	10mm x 60cm	10mm x 60cm	
8mm x 90cm	10mm x 90cm	10mm x 90cm	
8mm x 120cm	10mm x 120cm	10mm x 120cm	
8mm x 150cm	10mm x 150cm	10mm x 150cm	
8mm x 180cm	10mm x 180cm	10mm x 180cm	

## CL-809



1. Integrated Cable Lock
2. Reliable steel cable locks provide expedient protection
3. Vinyl coating protects bike
4. Lock pin spring out upon opening

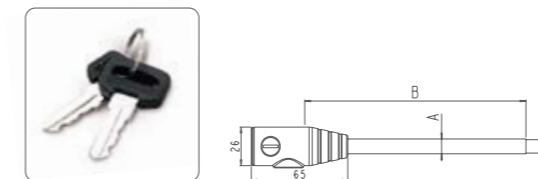

A	B
11mm x 60cm	
4mm steel wire, 11mm PVC tube	



# CABLE LOCK

Available in different colors and size Strong Cable

## CL-810 W/BL-719



1. Integrated Cable Lock
2. Reliable steel cable locks provide expedient protection
3. Vinyl coating protects bike
4. Carrying bracket including

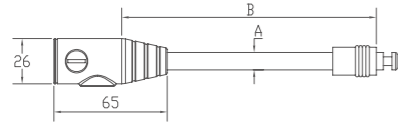

A	B	A	B	A	B
8mm	60cm	10mm	60cm	12mm	60cm
8mm	90cm	10mm	90cm	12mm	90cm
8mm	120cm	10mm	120cm	12mm	120cm
8mm	150cm	10mm	150cm	12mm	150cm
8mm	180cm	10mm	180cm	12mm	180cm

## CL-925 W/BL-714



1. Integrated Cable Lock
2. Reliable steel cable locks provide expedient protection
3. Vinyl coating protects bike
4. Carrying bracket including



A	B
8mm	60cm
8mm	90cm
8mm	120cm
8mm	150cm
8mm	180cm

## CL-926



1. Integrated Cable Lock
2. Reliable steel cable locks provide expedient protection
3. Vinyl coating protects bike

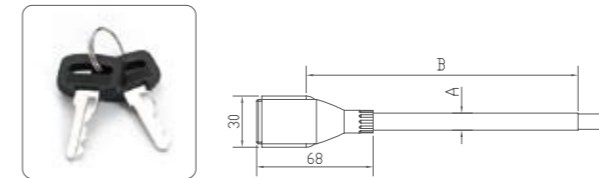

A	B
11mm	60cm
4mm steel wire, 11mm PVC tube	

## CL-428



1. Integrated Cable Lock
2. Reliable steel cable locks provide expedient protection
3. Vinyl coating protects bike

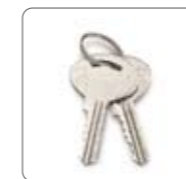
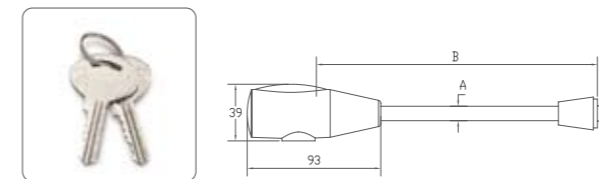

A	B
12mm	60cm
12mm	90cm
12mm	120cm
12mm	150cm
12mm	180cm



# CABLE LOCK

Available in different colors and size Strong Cable

## CL-429



1. Integrated Cable Lock
2. Reliable steel cable locks provide expedient protection
3. Vinyl coating protects bike

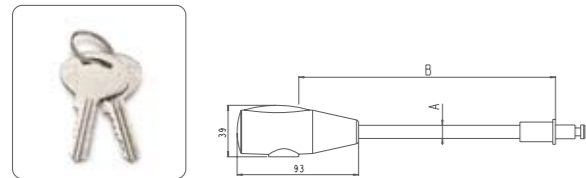

A	B
15mm	60cm
15mm	90cm
15mm	120cm
15mm	150cm
15mm	180cm

## CL-8100 W/BL-718



1. Integrated Cable Lock
2. Carrying bracket including
3. Patent design
4. Reliable steel cable locks provide expedient protection
5. Vinyl coating protects bike



A	B	A	B	A	B
8mm	60cm	10mm	60cm	12mm	60cm
8mm	90cm	10mm	90cm	12mm	90cm
8mm	120cm	10mm	120cm	12mm	120cm
8mm	150cm	10mm	150cm	12mm	150cm
8mm	180cm	10mm	180cm	12mm	180cm

## CL-811 W/BL-811



1. Integrated Cable Lock
2. Reliable steel cable locks provide expedient protection
3. Vinyl coating protects bike
4. Carrying bracket including



A	B	A	B
5mm	60cm	6mm	60cm
5mm	90cm	6mm	90cm
5mm	120cm	6mm	120cm
5mm	150cm	6mm	150cm
5mm	180cm	6mm	180cm

## CL-812



1. Integrated Cable Lock
2. Reliable steel cable locks provide expedient protection
3. Vinyl coating protects bike

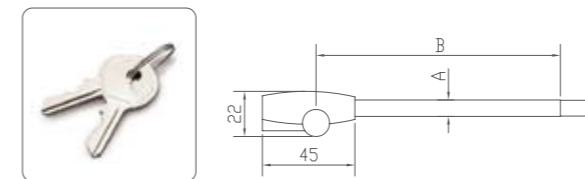

A	B
11mm	60cm
4mm steel wire, 11mm PVC tube	



# CABLE LOCK

Available in different colors and size Strong Cable

SW-610



1. Heavy duty security
2. Ideal for securing Bicycle, Motorcycle
3. Straight Cable

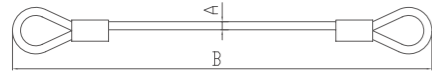

A	B	A	B	A	B	A	B
8mm	120cm	10mm	120cm	12mm	120cm	15mm	120cm
8mm	150cm	10mm	150cm	12mm	150cm	15mm	150cm
8mm	180cm	10mm	180cm	12mm	180cm	15mm	180cm

SW-611



1. Heavy duty security
2. Ideal for securing Bicycle, Motorcycle
3. Coil Cable

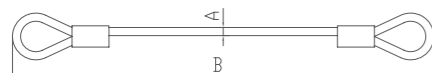

A	B	A	B	A	B	A	B
8mm	120cm	10mm	120cm	12mm	120cm	15mm	120cm
8mm	150cm	10mm	150cm	12mm	150cm	15mm	150cm
8mm	180cm	10mm	180cm	12mm	180cm	15mm	180cm

# HANDYWAY



# COMBINATION LOCK

[www.handywaylock.com.tw](http://www.handywaylock.com.tw)

# COMBINATION LOCK

CL-861



1. Integrated combination lock
2. Resettable code
3. Tough vinyl cable cover

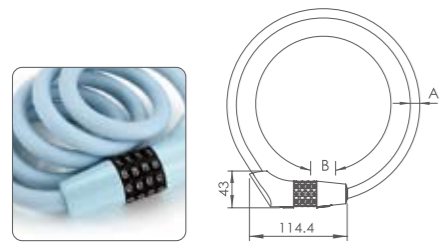

A	B	A	B
10mm x 60cm	12mm x 60cm		
10mm x 90cm	12mm x 90cm		
10mm x 120cm	12mm x 120cm		
10mm x 150cm	12mm x 150cm		
10mm x 180cm	12mm x 180cm		

CL-866



1. Flexible material coatings on the locking mechanism
2. Resettable code
3. Flexible TPE cable cover with different colors available

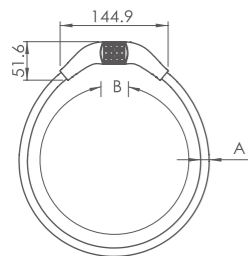

A	B	A	B
8mm x 60cm	10mm x 60cm		
8mm x 90cm	10mm x 90cm		
8mm x 120cm	10mm x 120cm		
8mm x 150cm	10mm x 150cm		
8mm x 180cm	10mm x 180cm		

CL-857 W/BL-718



1. Resettable code



A	B	A	B	A	B
8mm x 60cm	10mm x 60cm	12mm x 60cm			
8mm x 90cm	10mm x 90cm	12mm x 90cm			
8mm x 120cm	10mm x 120cm	12mm x 120cm			
8mm x 150cm	10mm x 150cm	12mm x 150cm			
8mm x 180cm	10mm x 180cm	12mm x 180cm			

CL-401 W/BL-718



1. Integrated Combination with Key Lock
2. Patent design
3. Carry Bracket Including
4. User Settable Combination
5. Vinyl Coating Protects Bikes
6. Anti-corrosion Brass Tumblers
7. Pin Finder can find out the encode



A	B	A	B	A	B	A	B
8mm x 60cm	10mm x 60cm	12mm x 60cm	15mm x 60cm				
8mm x 90cm	10mm x 90cm	12mm x 90cm	15mm x 90cm				
8mm x 120cm	10mm x 120cm	12mm x 120cm	15mm x 120cm				
8mm x 150cm	10mm x 150cm	12mm x 150cm	15mm x 150cm				
8mm x 180cm	10mm x 180cm	12mm x 180cm	15mm x 180cm				



# COMBINATION LOCK

## CL-402 W/BL-402



1. Integrated Combination Lock
2. Patent design
3. Carry Bracket Including
4. User Settable Combination
5. Vinyl Coating Protects Bikes
6. Anti-corrosion Brass Tumblers



A	B	A	B
10mm x 60cm	12mm x 60cm		
10mm x 90cm	12mm x 90cm		
10mm x 120cm	12mm x 120cm		
10mm x 150cm	12mm x 150cm		
10mm x 180cm	12mm x 180cm		

## CL-836 W/BL-888



1. Integrated combination lock
2. Resettable Code
3. Carry Bracket including

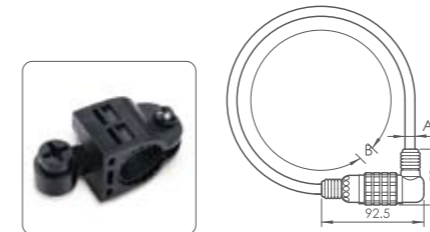

A	B	A	B	A	B
8mm x 60cm	10mm x 60cm	12mm x 60cm			
8mm x 90cm	10mm x 90cm	12mm x 90cm			
8mm x 120cm	10mm x 120cm	12mm x 120cm			
8mm x 150cm	10mm x 150cm	12mm x 150cm			
8mm x 180cm	10mm x 180cm	12mm x 180cm			

## CL-833 W/BL-718



1. Integrated combination lock
2. Resettable Code
3. Carry Bracket with patent design



A	B	A	B
8mm x 60cm	10mm x 60cm		
8mm x 90cm	10mm x 90cm		
8mm x 120cm	10mm x 120cm		
8mm x 150cm	10mm x 150cm		
8mm x 180cm	10mm x 180cm		

## CL-838 W/BL-726 or W/BL-888



1. Integrated combination lock
2. Resettable Code
3. Carry Bracket including



A	B	A	B	A	B
8mm x 60cm	10mm x 60cm	12mm x 60cm			
8mm x 90cm	10mm x 90cm	12mm x 90cm			
8mm x 120cm	10mm x 120cm	12mm x 120cm			
8mm x 150cm	10mm x 150cm	12mm x 150cm			
8mm x 180cm	10mm x 180cm	12mm x 180cm			

# COMBINATION LOCK

## CL-839 W/BL-718



1. Integrated combination lock
2. Resettable Code
3. Carry Bracket with patent design

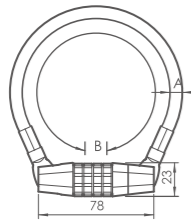

A	B	A	B
8mm x 60cm	10mm x 60cm		
8mm x 90cm	10mm x 90cm		
8mm x 120cm	10mm x 120cm		
8mm x 150cm	10mm x 150cm		
8mm x 180cm	10mm x 180cm		

## CL-853 W/BL-888



1. Integrated combination lock
2. Resettable Code
3. Carry Bracket including

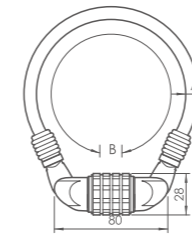

A	B	A	B	A	B
8mm x 60cm	10mm x 60cm			12mm x 60cm	
8mm x 90cm	10mm x 90cm			12mm x 90cm	
8mm x 120cm	10mm x 120cm			12mm x 120cm	
8mm x 150cm	10mm x 150cm			12mm x 150cm	
8mm x 180cm	10mm x 180cm			12mm x 180cm	

## CL-851 W/BL-718



1. V-shaped Integrated Cable Lock
2. Vinyl coating and scratch guard
3. Patented bracket is extremely convenient
4. Resettable Code

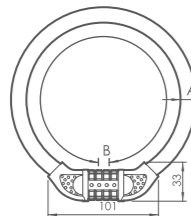

A	B	A	B	A	B	A	B
8mm x 60cm	10mm x 60cm			12mm x 60cm		15mm x 60cm	
8mm x 90cm	10mm x 90cm			12mm x 90cm		15mm x 90cm	
8mm x 120cm	10mm x 120cm			12mm x 120cm		15mm x 120cm	
8mm x 150cm	10mm x 150cm			12mm x 150cm		15mm x 150cm	
8mm x 180cm	10mm x 180cm			12mm x 180cm		15mm x 180cm	

## CL-855 W/BL-888



1. Intergrated Combination Lock
2. Reliable steel cable locks provide expedient protection
3. Vinyl coating protects bike
4. Resettable Code

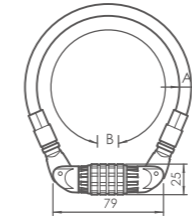

A	B	A	B
8mm x 60cm	10mm x 60cm		
8mm x 90cm	10mm x 90cm		
8mm x 120cm	10mm x 120cm		
8mm x 150cm	10mm x 150cm		
8mm x 180cm	10mm x 180cm		



# COMBINATION LOCK

## CL-835 W/BL-718



1. Integrated combination lock
2. Resettable Code
3. Carry Bracket including

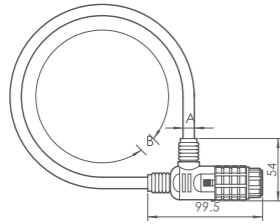

A	B	A	B	A	B
8mm x 60cm		10mm x 60cm		12mm x 60cm	
8mm x 90cm		10mm x 90cm		12mm x 90cm	
8mm x 120cm		10mm x 120cm		12mm x 120cm	
8mm x 150cm		10mm x 150cm		12mm x 150cm	
8mm x 180cm		10mm x 180cm		12mm x 180cm	

## CL-204P



1. Integrated combination lock
2. Vinyl coating protects bikes
3. Resettable Code

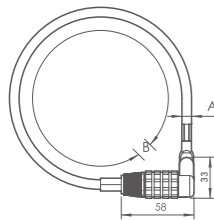

A	B	A	B	A	B
5mm x 60cm		6mm x 60cm		8mm x 60cm	
5mm x 90cm		6mm x 90cm		8mm x 90cm	
5mm x 120cm		6mm x 120cm		8mm x 120cm	
5mm x 150cm		6mm x 150cm		8mm x 150cm	
5mm x 180cm		6mm x 180cm		8mm x 180cm	

## CL-350/300S



1. Preset Combination Lock
2. Vinyl coating protects bike

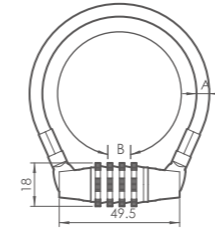

A	B	A	B
5mm x 60cm		6mm x 60cm	
5mm x 90cm		6mm x 90cm	
5mm x 120cm		6mm x 120cm	
5mm x 150cm		6mm x 150cm	
5mm x 180cm		6mm x 180cm	

## CL-350/500D



1. Preset Combination Lock
2. Vinyl coating protects bike

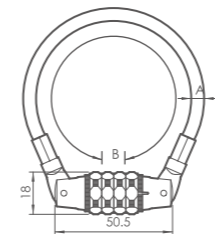

A	B	A	B
5mm x 60cm		6mm x 60cm	
5mm x 90cm		6mm x 90cm	
5mm x 120cm		6mm x 120cm	
5mm x 150cm		6mm x 150cm	
5mm x 180cm		6mm x 180cm	

# U-LOCK

## UL-1002



1. 12mm hardened steel shackle, The diameter of shackle with PVC: 14mm
2. 2 Finland keys

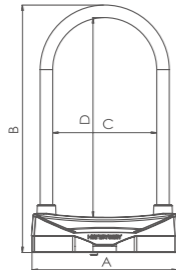

Shackle diameter	Outside		Inside		Weight	Pulling test
	A	B	C	D		
12mm	162mm	253mm	116mm	200mm	1080g	1500kg
	162mm	331mm	116mm	278mm	1135g	1500kg

## UL-801



1. Mini U lock
2. Shackle Hardened steel
3. 7 pin round-key cylinder

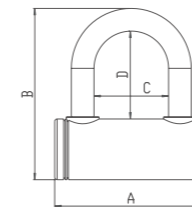

Shackle diameter	Outside		Inside		Weight	Pulling test
	A	B	C	D		
14mm	95mm	90mm	43mm	40mm	500g	3000kg

## UL-802 W/BL-718 or W/BL-108



1. 12mm hardened steel shackle, The Diameter of shackle with PVC: 14mm
2. High security disc-style cylinder
3. Sliding dustcover protects cylinder

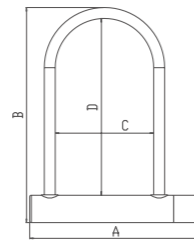

Shackle diameter	Outside		Inside		Weight	Pulling test
	A	B	C	D		
12mm	180mm	245mm	108mm	200mm	832g	500kg
	180mm	320mm	108mm	270mm	980g	500kg

## UL-805



1. Mini U combination Lock
2. Shackle Hardened steel

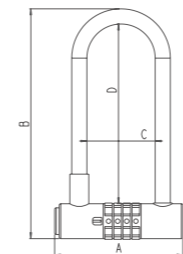

Shackle diameter	Outside		Inside		Weight	Pulling test
	A	B	C	D		
10mm	80mm	80mm	45mm	48mm	237g	200kg
	80mm	170mm	45mm	142mm	357g	200kg



# U-LOCK

UL-807 W/BL-718



1. Shackle Hardened steel
2. 7 pin round-key cylinder
3. Carrying bracket with patent design

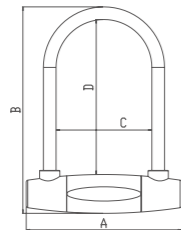

Shackle diameter	Outside		Inside		Weight	Pulling test
	A	B	C	D		
14mm	170mm	260mm	106mm	200mm	867g	2000kg
	170mm	335mm	106mm	278mm	1390g	2000kg

UL-816 W/BL-722



1. 2 Finland keys, steel U shackle
2. Lock body: black & silver

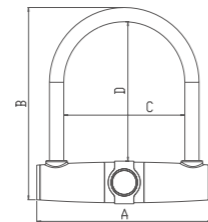

Shackle diameter	Outside		Inside		Weight	Pulling test
	A	B	C	D		
12mm	171mm	175mm	114mm	127mm	950g	2000kg
	171mm	341mm	114mm	292mm	1150g	2000kg

# POCKET LOCK

STL-2500C



1. Quick and easy to use security
2. Resettable combination lock

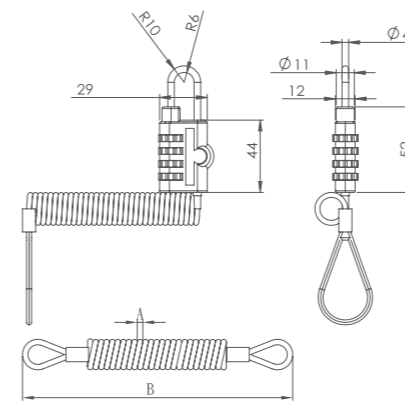

A	B
2.4mm x 120cm	
2.4mm x 150cm	
2.4mm x 180cm	

STL-2900C



1. Quick and easy to use security
2. Resettable combination with key lock

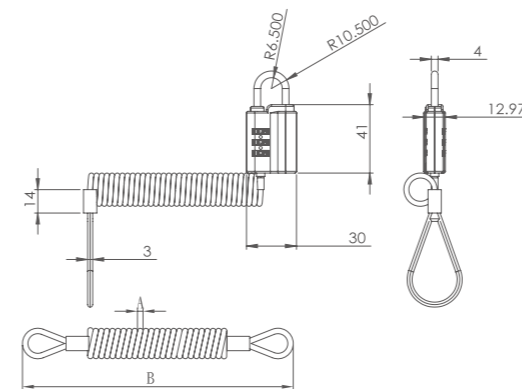

A	B
2.4mm x 120cm	
2.4mm x 150cm	
2.4mm x 180cm	

# POCKET LOCK

## SKL-3000C



1. Quick and easy to use security
2. Resettable combination Lock

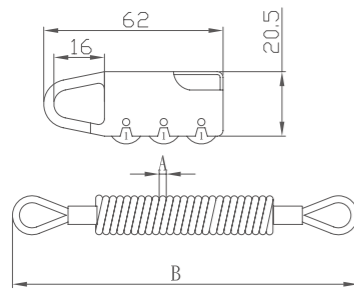

A	B
2.4mm x 120cm	
2.4mm x 150cm	
2.4mm x 180cm	

## SKL-7000C



1. Quick and easy to use security
2. Resettable combination Lock

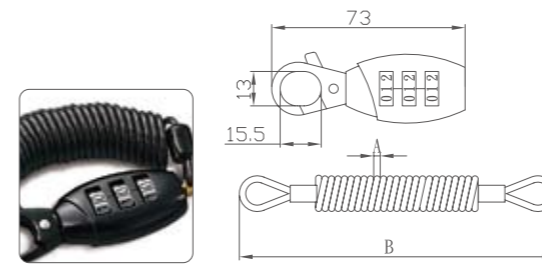

A	B
2.4mm x 120cm	
2.4mm x 150cm	
2.4mm x 180cm	

## SKL-6000C



1. Quick and easy to use security
2. Resettable combination Lock

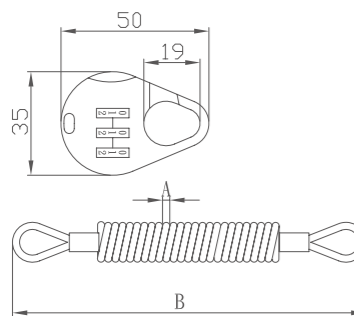

A	B
2.4mm x 120cm	
2.4mm x 150cm	
2.4mm x 180cm	

## SKL-8000C



1. Quick and easy to use security
2. Resettable combination Lock

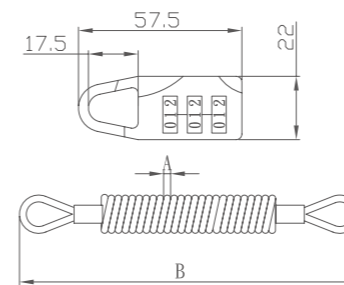

A	B
2.4mm x 120cm	
2.4mm x 150cm	
2.4mm x 180cm	



HANDYWAY



RETRACTABLE LOCK

[www.handywaylock.com.tw](http://www.handywaylock.com.tw)

## RETRACTABLE LOCK

STL-2600C



1. Pocket size for easy carrying
2. Extra flexible steel cable
3. Diameter: 1.5mm, Length: 120cm

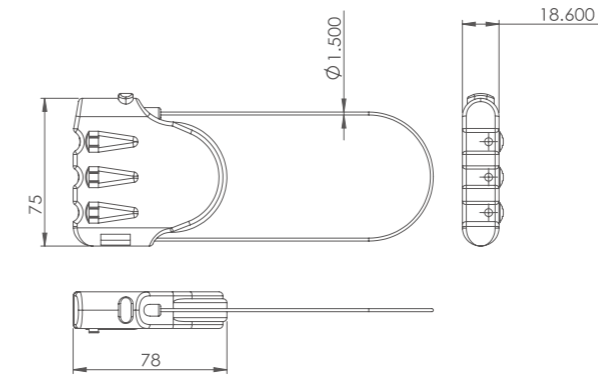

STL-2800C



1. Pocket size for easy carrying
2. Extra flexible steel cable
3. Diameter: 1.5mm, Length: 120cm

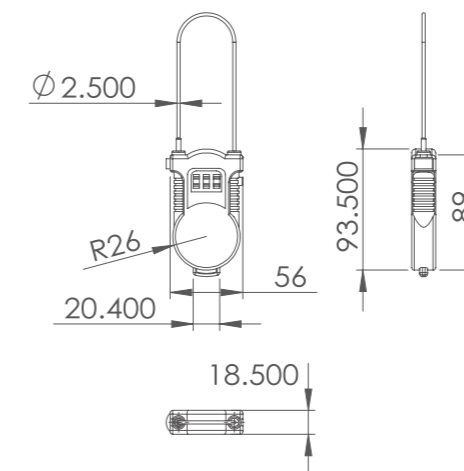

# RETRACTABLE LOCK

RLC-01



1. Pocket size for easy carrying
2. Extra flexible steel cable
3. Suitable for applying to items like helmet, sled or luggage...etc
4. Diameter: 2.2mm, Length: 100cm

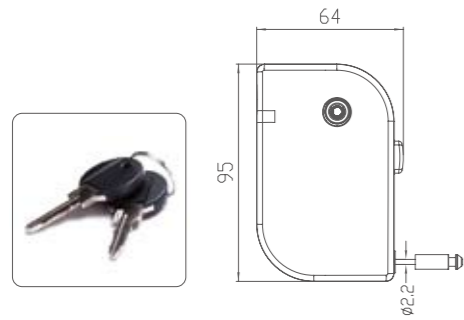

RLB-01



1. Set your own digit combination
2. Pocket size for easy carrying
3. Extra flexible steel cable
4. Suitable for applying to items like helmet, sled or luggage...etc
5. Diameter: 2.2mm, Length: 100cm

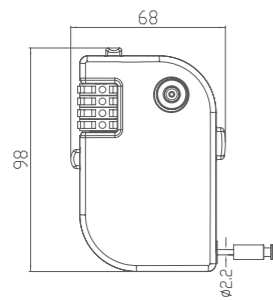

# FOLDING LOCK

FL-511 W/BACKET



1. Anti-drill key cylinder
2. Ultra hardened steel plate 5mm
3. Extra-strengthened, impact-resistant housing
4. Link plate design for compact folding.
5. Weight: 1110g

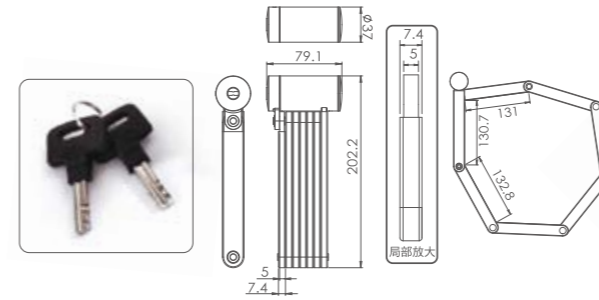

FL-512 W/BACKET



1. Resettable code.
2. Ultra hardened steel plate 5mm
3. Extra-strengthened, impact-resistant housing
4. Link plate design for compact folding.
5. Weight: 1130g

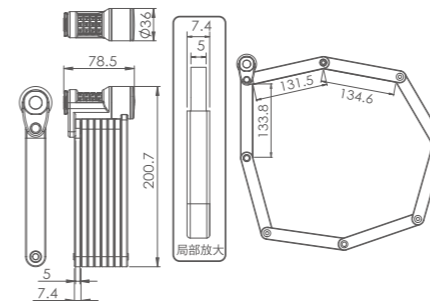





**FRAME LOCK**

[www.handywaylock.com.tw](http://www.handywaylock.com.tw)

**FRAME LOCK**

FL-301



- 1. Specially hardened shackle
- 2. Extra-strengthened, Impact-resistant, Hardened steel casing
- 3. Weight: 424g

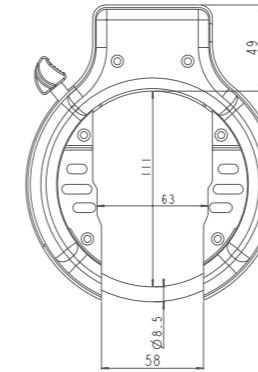

FL-502



- 1. Specially hardened shackle
- 2. Extra-strengthened, Impact-resistant, Hardened steel casing
- 3. Weight: 576g

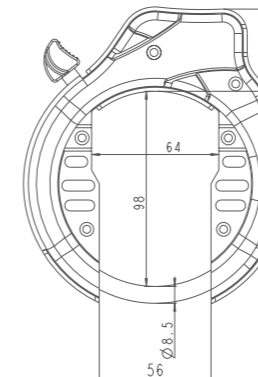
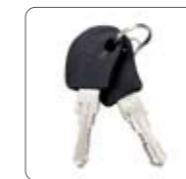





**RACK LOCK**  
www.handywaylock.com.tw

# RACK LOCK

CLF-01



1. Cable can be storage into rack tube

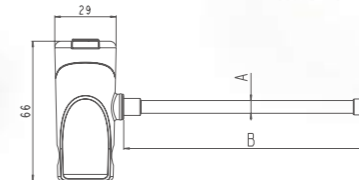
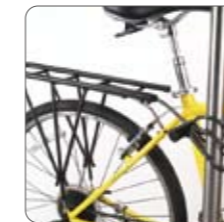

A	B	Pulling test
8mm x 100cm		500lb

UL-922



1. Shackle- lock with carrier function  
2. Capacity: suggest under 10kgs

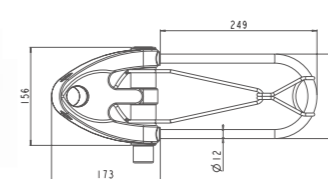
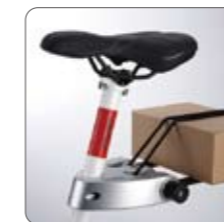

Pulling test
1000lb





**DISK LOCK**  
www.handywaylock.com.tw

# DISK LOCK

HD-9005



1. Disk lock with special design
2. Disk lock with disk reminder
3. The disk reminder prevents riding away while disk lock is still engaged
4. 7mm, 10mm or 12.7mm size

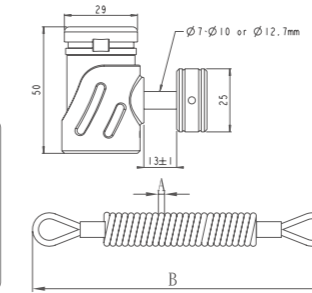

A	B
4mm x 120cm	
4mm x 150cm	
4mm x 180cm	

HD-9004



1. Disk lock with special design
2. Disk lock with disk reminder
3. The disk reminder prevents riding away while disk lock is still engaged
4. 10mm or 12.7mm size
5. 6 pin flat key cylinder

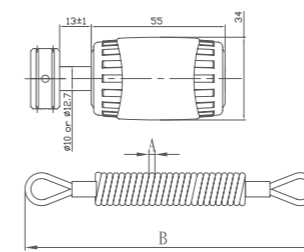

A	B
4mm x 120cm	
4mm x 150cm	
4mm x 180cm	





**MULTI-PURPOSE**

[www.handywaylock.com.tw](http://www.handywaylock.com.tw)

**CL-453**



- 1. Ideal for securing bicycle with variety objects
- 2. With storage pouch

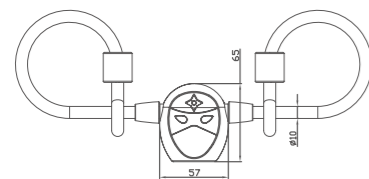

A	B
10mm x 60cm	
10mm x 90cm	
10mm x 120cm	
10mm x 150cm	
10mm x 180cm	

**MULTI-PURPOSE**

**STL-F65**



- 1. Heavy duty security
- 2. Ideal for securing Bicycle. Motorcycle. ATV's. Boats. Lawn Equipment

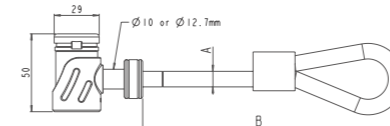

A	B	A	B	A	B
8mm x 120cm		10mm x 120cm		12mm x 120cm	
8mm x 150cm		10mm x 150cm		12mm x 150cm	
8mm x 180cm		10mm x 180cm		12mm x 180cm	

**CL-413 Helmet Lock + Cable**



- 1. Material: Zinc alloy, Lock body ED black finish, lock top chrome plated
- 2. A: Dia.: 25.4~31.8mm w/2 keys
- 3. Cable Size: 10mm (B) X 1200mm (C) w/1pc velcro

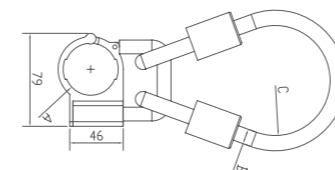



# MULTI-PURPOSE

SW-610 W/UL-801



1. Heavy duty security
2. Ideal for securing Bicycle. Motorcycle

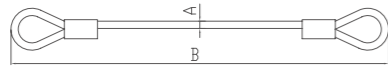

A	B	A	B	A	B	A	B
8mm	120cm	10mm	120cm	12mm	120cm	15mm	120cm
8mm	150cm	10mm	150cm	12mm	150cm	15mm	150cm
8mm	180cm	10mm	180cm	12mm	180cm	15mm	180cm

# HANDYWAY



**PAD LOCK**  
www.handywaylock.com.tw

STL-C200



1. Heavy duty security
2. Ideal for securing Bicycle. Motorcycle. ATV's. Boats. Lawn Equipment

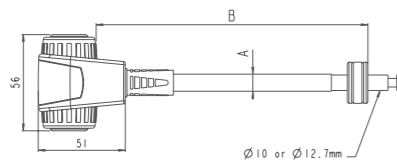

A	B	A	B	A	B
8mm	120cm	10mm	120cm	12mm	120cm
8mm	150cm	10mm	150cm	12mm	150cm
8mm	180cm	10mm	180cm	12mm	180cm

WF-04



1. Stronghold anchor with cable
2. Extra secure locking point for use indoors and out providing a convenient place for locking valuable equipment
3. Attach to ground, wall, truck or trailer bed
4. 2 bolts, 2 crews, 2 steel balls
5. Recommended for both residential and commercial applications

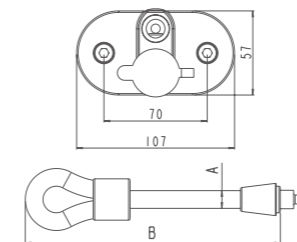

A	B	A	B
10mm	150cm	12mm	150cm
10mm	180cm	12mm	180cm
10mm	210cm	12mm	210cm

# PAD LOCK

WF-03



1. Stronghold Anchor
2. Extra secure locking point for use indoors and out providing a convenient place for locking valuable equipment
3. Attach to ground, wall, truck or trailer bed
4. 13mm hardened carbon alloy steel shackle
5. 2 bolts, 2 screws, 2 steel balls
6. Steel shackle lays flat within domed body when not in use, making anchor safe to drive or walk over
7. Recommended for both residential and commercial applications

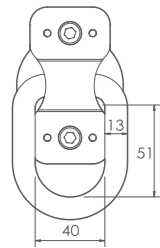

PD-04



1. Amored hardened steel case
2. Hardened steel shackle



40mm, 50mm

PD-05



1. Round disk Padlock
2. 70mm armor protected shackle



40mm, 50mm, 70mm

PD-07



1. Preset combination Padlock
2. Hardened steel shackle



40 OR 50mm

40mm, 50mm

PD-08



1. Laminated steel padlock with plated steel body
2. Hardened steel shackle



40mm, 50mm

PD-05



1. 6mm hardened steel shackle resists bolt cutters and leverage attacks
2. Protective nylon cover

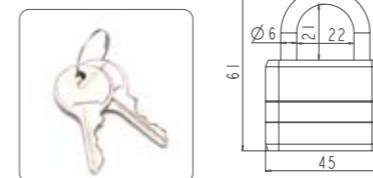

45mm





# HEAVY DUTY CHAIN / JOINT LOCK

[www.handywaylock.com.tw](http://www.handywaylock.com.tw)

CHL-516



1. Dust cover protects keyway from natural elements
2. 8mm x 8mm x 100cm (A) original size
3. Nylon cover won't chip your paint

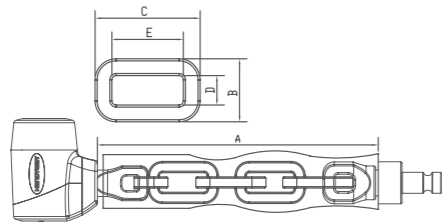

	Dia.6mm	Dia.8mm	A
B	24mm	32mm	6mm x 6mm x 100cm
C	43mm	50mm	8mm x 8mm x 100cm
D	11mm	16mm	10mm x 10mm x 100cm
E	31mm	34mm	

# HEAVY DUTY CHAIN / JOINT LOCK

CHL-513



1. Chain with padlock + belt lock
2. Durable soft nylon sleeve provides scratch protection

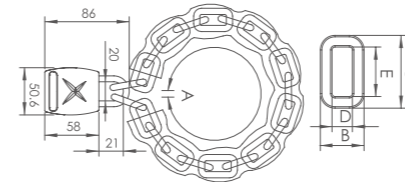

	Dia.6mm	Dia.8mm	A
B	24mm	32mm	6mm x 6mm x 100cm
C	43mm	50mm	8mm x 8mm x 100cm
D	11mm	16mm	10mm x 10mm x 100cm
E	31mm	34mm	

CHL-514



1. Chain lock
2. The surface of lock head: Chrome finish
3. Durable soft nylon sleeve provides scratch protection
4. Size: 8mm x 8mm x 90cm (A)

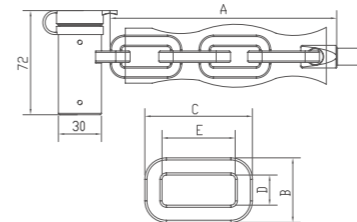

	Dia.6mm	Dia.8mm	A
B	24mm	32mm	6mm x 6mm x 100cm
C	43mm	50mm	8mm x 8mm x 100cm
D	11mm	16mm	
E	31mm	34mm	

# HEAVY DUTY CHAIN / JOINT LOCK

HL-666



1. Chain Lock: 8mm x 8mm x 90cm (A)
2. Nylon cover won't chip your paint
3. The Surface of lock head: Anodized. Available in different colors
4. 2 Finland keys

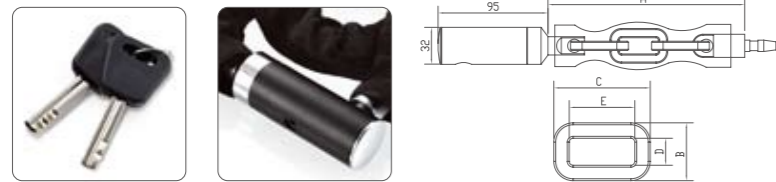

	Dia.8mm	A
B	32mm	8mm x 8mm x 90cm
C	50mm	
D	16mm	
E	34mm	

HL-220



1. Nylon cover won't chip your paint
2. V-shaped lock head

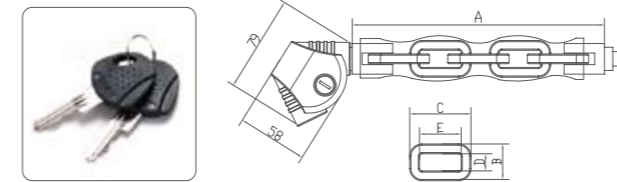

	Dia.6mm	Dia.8mm	A
B	24mm	32mm	6mm x 6mm x 100cm
C	43mm	50mm	8mm x 8mm x 100cm
D	11mm	16mm	10mm x 10mm x 100cm
E	31mm	34mm	

CP-001



1. Chain with Padlocks
2. Nylon cover won't chip your paint

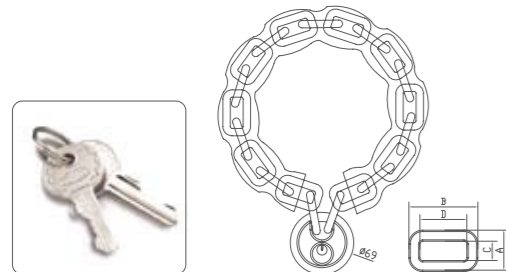

	Dia.6mm	Dia.8mm	A
B	24mm	32mm	6mm x 6mm x 100cm
C	43mm	50mm	8mm x 8mm x 100cm
D	11mm	16mm	10mm x 10mm x 100cm
E	31mm	34mm	

AC-101 W/VELCRO



1. Steel Sleeve Resists Cutting and Sawing
2. Vinyl Coating Prevents Scratches Professional Lock
3. Sliding Dust Cover Protects Keyway From Natural Elements

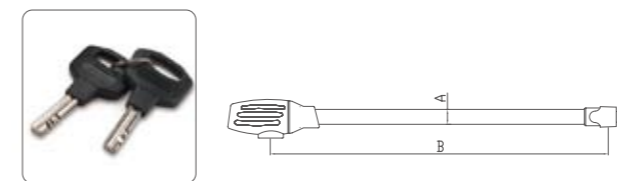

	A	B	A	B	A	B
	18mm	60cm	18mm	90cm	18mm	120cm



# CYLINDER



KF-01



KF-08



KL-01



KF-02



KF-09



KBL-01



KF-03



KF-10



KBL-02



KF-04



KF-11



KBL-03



KF-06



KF-12



KBL-04



KF-07



KR-01



KBL-05

# HANDYWAY

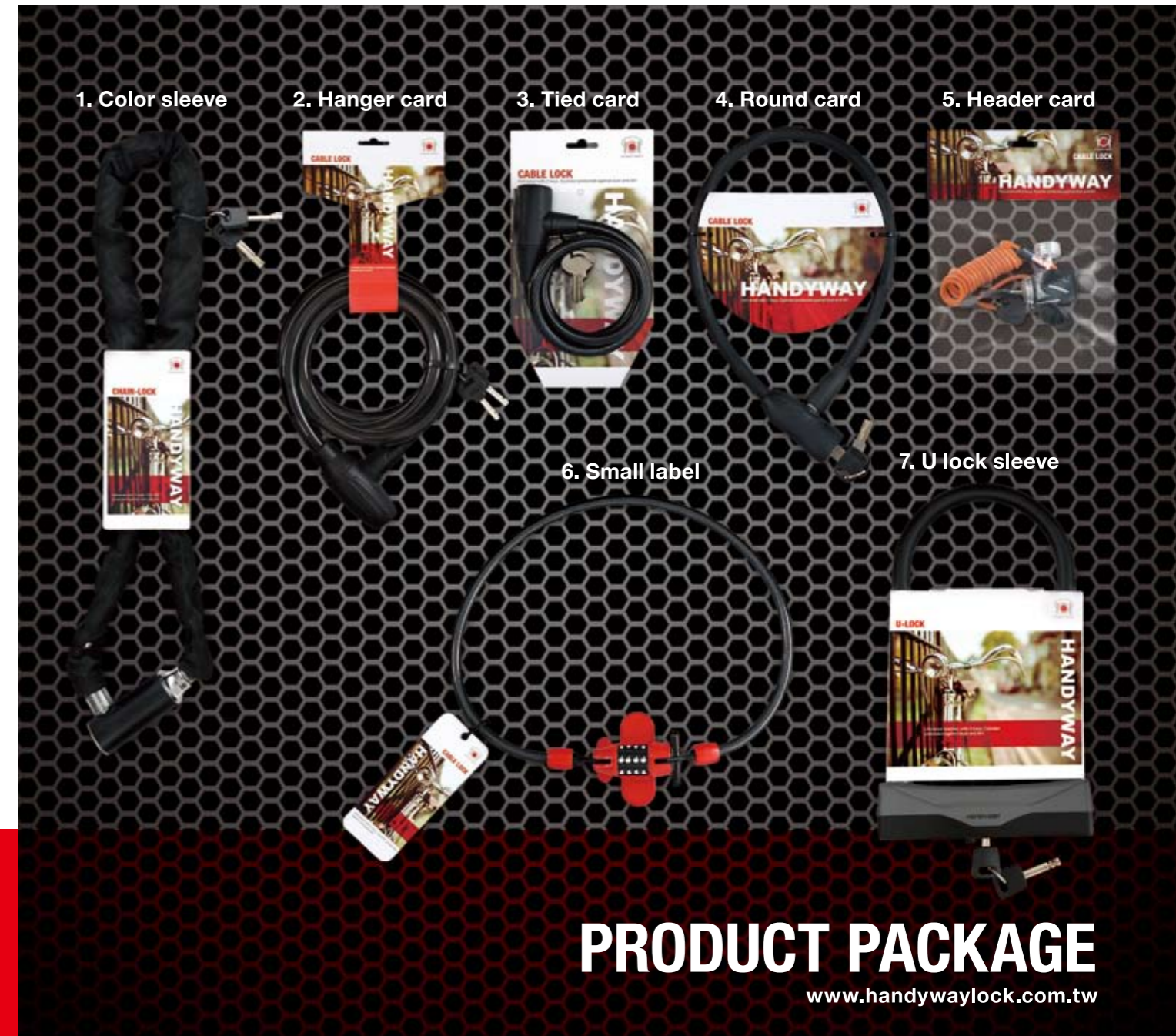

1. Color sleeve

2. Hanger card

3. Tied card

4. Round card

5. Header card

6. Small label

7. U lock sleeve

**PRODUCT PACKAGE**

[www.handywaylock.com.tw](http://www.handywaylock.com.tw)